











mermaid  
at

ARTICLES  
POUR  
VAPOTEURS

ARTICLES  
POUR  
VAPOTEURS

ARTICLES  
POUR  
VAPOTEURS

ARTICLES  
POUR  
VAPOTEURS

ARTICLES  
POUR  
VAPOTEURS



# PRR Student Build Project

IDEAS Studio

Today's Date: 5/26/2017 Friday  
(vertical red line)

Project Lead: Richard Klopp  
Start Date: 5/1/2017 Monday

First Day of Week (Mon=2): 2

WBS	Tasks	Task Lead	Start	End	Duration (Days)	% Complete	Working Days	Days Complete	Days Remaining	1-May-17	8-May-17	15-May-17	22-May-17	29-May-17	5-Jun-17	12-Jun-17	19-Jun-17	26-Jun-17	3-Jul-17
<b>1</b>	<b>ADMINISTRATION</b>	VANIER	5/2/17	6/14/17	44	0%	32	0	44										
1.1	Signed Agreement	VANIER	5/2/17	5/2/17	1	100%	1	1	0										
1.2	Finalised Budget	VAN/STL	5/29/17	5/29/17	1	0%	1	0	1										
1.3	Procurement	VANIER	5/5/17	6/14/17	0	0%	1	0	0										
1.3.1	Student cheques	IDEAS	5/5/17	5/5/17	1	0%	1	0	1										
1.3.2	Materials	IDEAS	5/25/17	5/25/17	1	0%	1	0	1										
1.3.3	Service Contract	IDEAS	6/14/17	6/14/17	1	0%	1	0	1										
1.4	Team list for Insur.	IDEAS	5/26/17	5/26/17	1	0%	1	0	1										
<b>2</b>	<b>FINALIZE DESIGN</b>		5/2/17	5/26/17	25	12%	19	3	22										
2.1	Coordination Meeting	VSL/ID	5/10/17	5/10/17	1	0%	1	0	1										
2.2	Design Development	IDEAS	5/2/17	5/16/17	15	17%	11	2	13										
2.3	Design Review	VSL/ID	5/17/17	5/17/17	1	0%	1	0	1										
2.4	Construction Plans	IDEAS	5/17/17	5/23/17	7	0%	5	0	7										
2.5	Final Approval	VSL	5/24/17	5/26/17	3	25%	3	0	3										
2.6	Cut Lists	IDEAS	5/23/17	5/25/17	3	0%	3	0	3										
<b>3</b>	<b>CONSTRUCTION</b>		5/24/17	6/27/17	35	0%	25	0	35										
3.1	Team Briefing	IDEAS	5/24/17	5/24/17	1	0%	1	0	1										
3.2	Material delivery	VANIER	5/31/17	5/31/17	1	0%	1	0	1										
3.3	Construction	IDEAS	6/1/17	6/20/17	20	0%	14	0	20										
3.4	Prep for delivery	IDEAS	6/21/17	6/27/17	7	0%	5	0	7										
<b>4</b>	<b>DELIVERY</b>		6/14/17	7/1/17	18	0%	13	0	18										
4.1	Coordination Meeting	VSL/ID	6/14/17	6/14/17	1	0%	1	0	1										
4.2	Delivery	VSL	6/28/17	6/28/17	1	0%	1	0	1										
4.3	Site Assembly	VSL	6/28/17	6/30/17	3	0%	3	0	3										
4.4	Inauguration	IDEAS	7/1/17	7/1/17	1	0%	0	0	1										



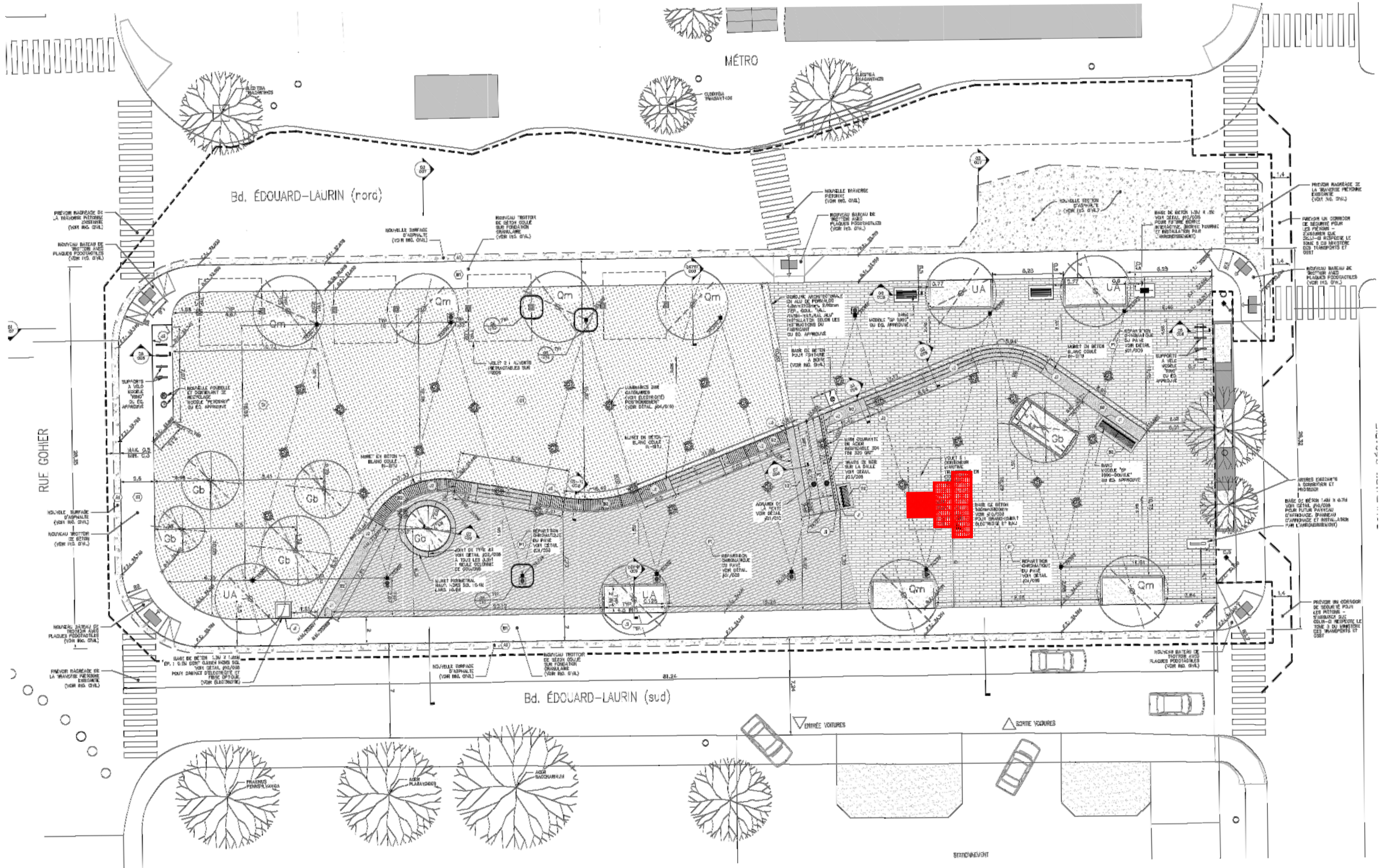

MÉTRO

Bd. ÉDOUARD-LAURIN (nord)

RUE GOHIER

Bd. ÉDOUARD-LAURIN (sud)

ENTRÉE VEHICULES

SORTIE VEHICULES

STATIONNEMENT







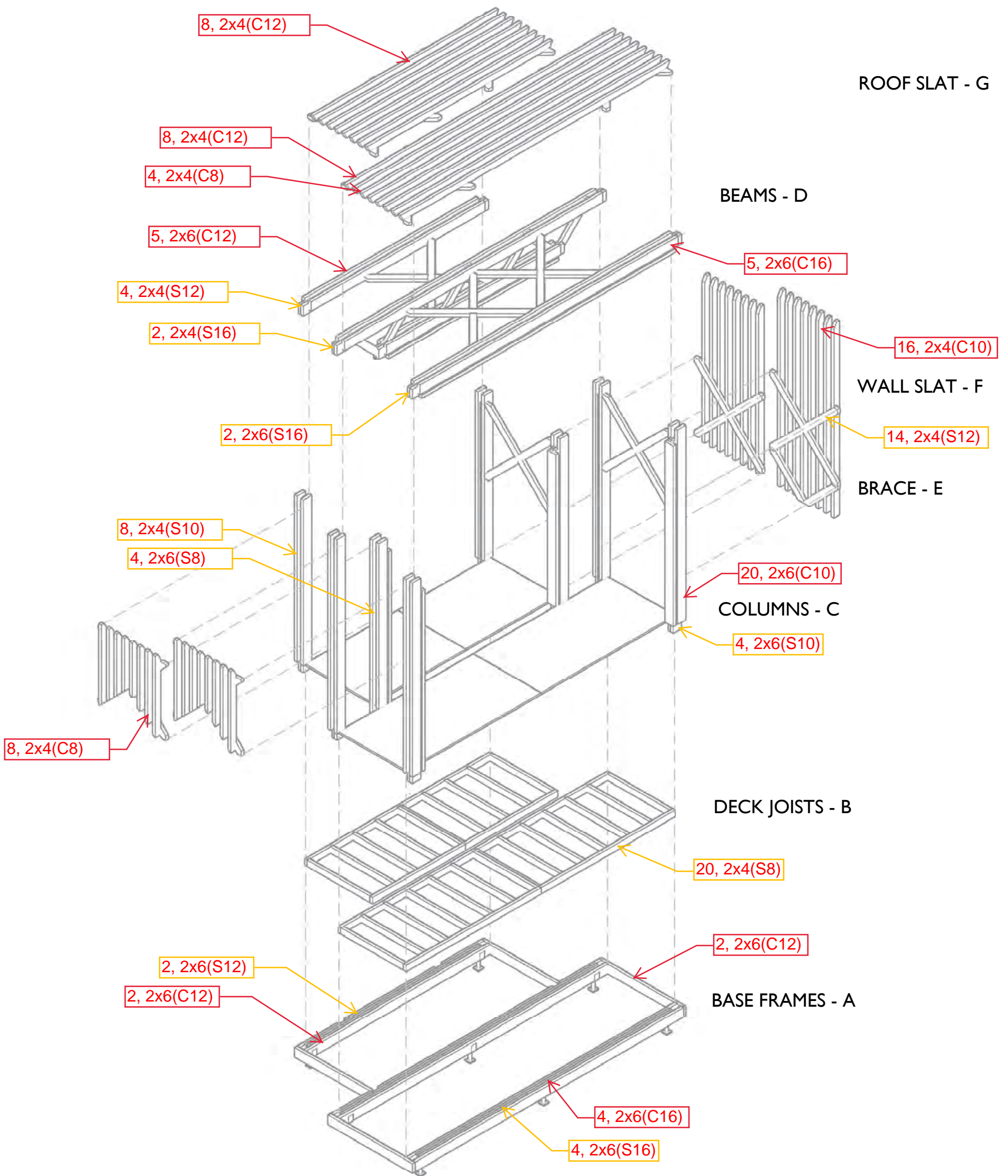

PRR - Student Design-Build Project

**FINAL MATERIAL LIST**

Supplier 1 L'Entrepôt RONA  
3600 Boulevard de la Côte-Vertu, Saint-Laurent, QC H4R 1P8

Code	Description	Quantity	Unit Cost	Total	
938038	3/4x4x8 - Plywood Pine ACX	Stage deck surface	4	\$50.78 2.50%	198.04
10555004	Cedar - 2 in x 6 in x 16 ft	Base beam - front deck	7	\$36.76	257.32
10555002	Cedar - 2 in x 6 in x 12 ft	Base beam - middle deck	4	\$25.62 2.50%	99.92
10555001	Cedar - 2 in x 6 in x 10 ft	Base edges	4	\$21.16 2.50%	82.52
971073	2x4x8 - Spruce Select	Floor structure	20	\$3.69 2.50%	71.96
10555001	Cedar - 2 in x 6 in x 10 ft	Frames - verticals	20	\$21.16 2.50%	412.62
971080	2x6x10 - Spruce Select	Front frames - verticals (inside)	8	\$7.30 2.50%	56.94
971074	2x4x10 - Spruce Select	Front frames - verticals (inside)	8	\$4.58 2.50%	35.72
971077	2x4x12 - Spruce Select	Cross bracing	16	\$4.58 2.50%	71.45
10555004	Cedar - 2 in x 6 in x 16 ft	Roof beam - front	5	\$36.76	183.80
60855021	2x6x16 - Spruce Select	Roof beam - front (inside) + spare	6	\$11.12 2.50%	65.05
60855017	2x4x16 - Spruce Select	Roof beam - front (inside)	2	\$7.72 2.50%	15.05
10555002	Cedar - 2 in x 6 in x 12 ft	Roof beam - middle	5	\$25.62 2.50%	124.90
971152	2x6x12 - Spruce Select	Roof beam - middle (inside) + spare	4	\$8.33 2.50%	32.49
971077	2x4x12 - Spruce Select	Roof beam - middle (inside)	2	\$5.99 2.50%	11.68
10555002	Cedar - 2 in x 6 in x 12 ft	Back beam	1	\$25.62 2.50%	24.98
971152	2x6x12 - Spruce Select	Back beam (inside)	1	\$8.33 2.50%	8.12
10555000	Cedar - 2 in x 6 in x 8 ft	Back frames - verticals	4	\$16.45 2.50%	64.16
971080	2x6x10 - Spruce Select	Back frames - verticals (inside)	4	\$7.30 2.50%	28.47
8351003	Cedar D4S - 2 in x 4 in x 12 ft	Slats roof	16	\$12.98 2.50%	202.49
8351002	Cedar D4S - 2 in x 4 in x 10 ft	Slats right	16	\$12.09 2.50%	188.60
8351001	Cedar D4S - 2 in x 4 in x 8 ft	Slats - front ceiling & over	12	\$9.29 2.50%	108.69
80645132	Deck Adjustable Support - 3x3 to 6x6", Steel - Black	Leveling posts	8	\$13.99 2.50%	109.12
63869666	2.5" - #8 Deck Screws - Box of 1300	Standard project screw	1	\$39.99 10.00%	35.99
63868899	1.5" Deck screws	Plywood screws	1	\$8.99 10.00%	8.09
1137169	#8 Screw Digger Bit	Countersinking bit	2	\$15.79 10.00%	28.42
19595014	Polyethylene Tarpaulin, White - 15 ft x 20 ft	Shelter	1	\$22.99	22.99
14495279	Thompson's water sealer	Moisture protection	1	\$15.99 15.00%	13.59
8124001	Paint set	Paint set	2	\$13.99 15.00%	23.78
				<b>2,586.96</b>	
					129.35
					258.05
					<b>2,974.36</b>

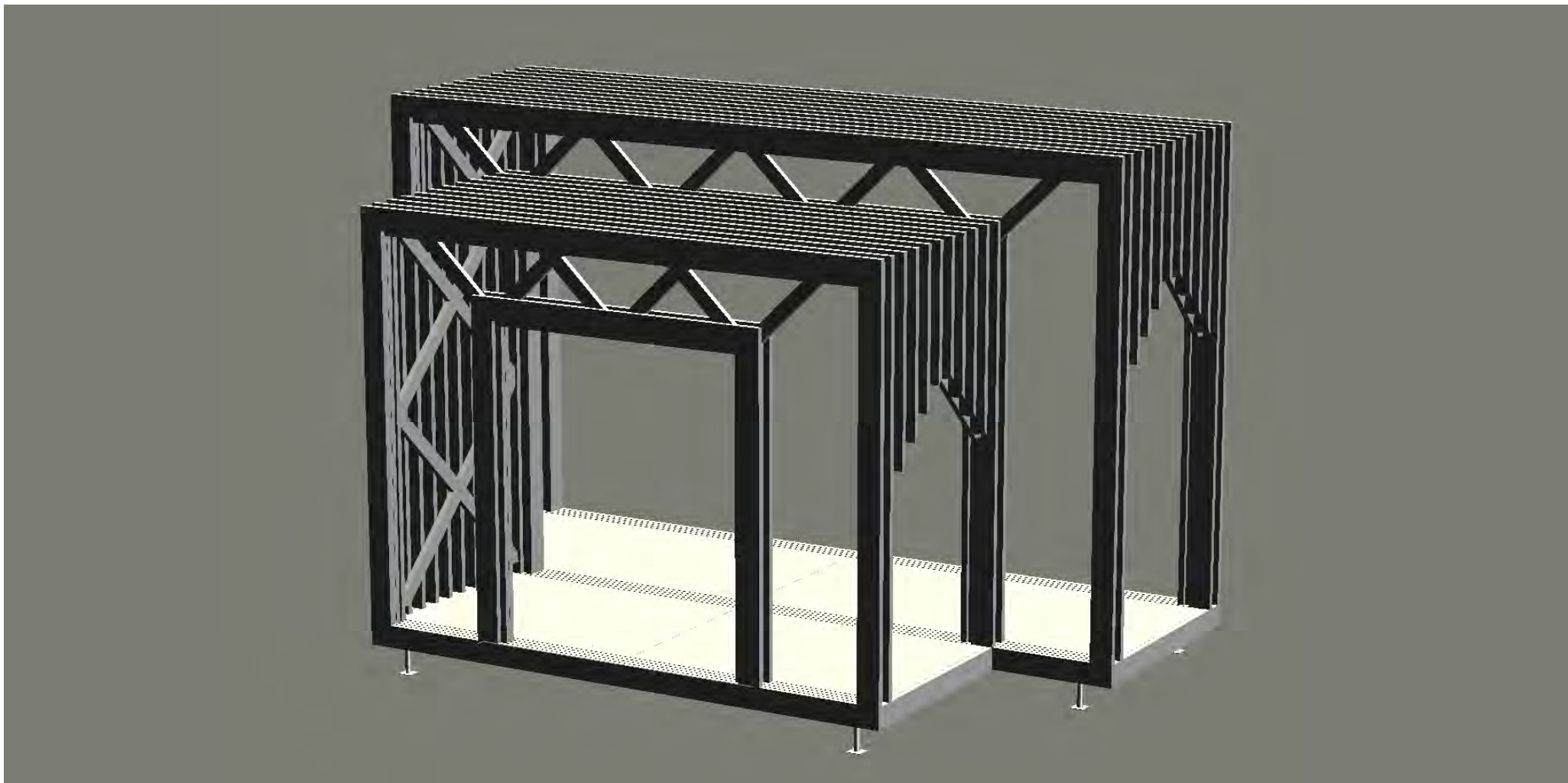





<b>Title:</b> PRR Student Design-Build Project  <b>Requestor/Recipient:</b> Richard Walter Klopp 221 - Architecture	<b>Creation date</b> May 25, 2017  <b>Target date</b> June 2, 2017	<b>Currency</b> CAD
--	--	------------------------

**Items on the requisition**

Item	Quantity	Format	Description	Unit cost	GST (%)	QST (%)	Amount
1	4	un	767-7021-00-549 938038 3/4x4x8 - Plywood Pine ACX Stage deck surface Room:C-106	49,51	5	9,975	198,04
2	12	un	767-7021-00-549 10555004 Cedar - 2 in x 6 in x 16 ft Room:C-106	36,76	5	9,975	441,12
3	10	un	767-7021-00-549 10555002 Cedar - 2 in x 6 in x 12 ft Room:C-106	24,98	5	9,975	249,80
4	24	un	767-7021-00-549 10555001 Cedar - 2 in x 6 in x 10 ft Room:C-106	20,63	5	9,975	495,12
5	20	un	767-7021-00-549 971073 2x4x8 - Spruce Select Room:C-106	3,60	5	9,975	72,00
6	12	un	767-7021-00-549 971080 2x6x10 - Spruce Select Room:C-106	7,12	5	9,975	85,44
7	8	un	767-7021-00-549 971074 2x4x10 - Spruce Select Room:C-106	4,47	5	9,975	35,76
8	18	un	767-7021-00-549 971077 2x4x12 - Spruce Select Room:C-106	5,84	5	9,975	105,12
9	6	un	767-7021-00-549 60855021 2x6x16 - Spruce Select Room:C-106	10,84	5	9,975	65,04
10	2	un	767-7021-00-549 60855017 2x4x16 - Spruce Select Room:C-106	7,53	5	9,975	15,06
11	5	un	767-7021-00-549 971152 2x6x12 - Spruce Select Room:C-106	8,12	5	9,975	40,60
12	4	un	767-7021-00-549 10555000 Cedar - 2 in x 6 in x 8 ft Room:C-106	16,04	5	9,975	64,16
13	16	un	767-7021-00-549 8351003 Cedar D4S - 2 in x 4 in x 12 ft Room:C-106	12,65	5	9,975	202,40
14	16	un	767-7021-00-549 8351002	11,79	5	9,975	188,64





Items on the requisition

Item	Quantity	Format	Description	Unit cost	GST (%)	QST (%)	Amount
			Cedar D4S - 2 in x 4 in x 10 ft Room:C-106				
15	12	un	767-7021-00-549 8351001 Cedar D4S - 2 in x 4 in x 8 ft Room:C-106	9,06	5	9,975	108,72
16	8	un	767-7021-00-549 80645132 Deck Adjustable Support - 3x3 to 6x6", Steel - Black Room:C-106	13,64	5	9,975	109,12
17	1	un	767-7021-00-549 63869666 2.5" - #8 Deck Screws - Box of 1300 Room:C-106	35,99	5	9,975	35,99
18	1	un	767-7021-00-549 63868899 1.5" Deck screws Room:C-106	8,09	5	9,975	8,09
19	2	un	767-7021-00-549 1137169 #8 Screw Digger Bit Room:C-106	14,21	5	9,975	28,42
20	1	un	767-7021-00-549 19595014 Polyethylene Tarpaulin, White - 15 ft x 20 ft Room:C-106	22,99	5	9,975	22,99
21	1	un	767-7021-00-549 14495279 Thompson's water sealer Room:C-106	13,59	5	9,975	13,59
22	2	un	767-7021-00-549 8124001 Paint set Room:C-106	11,89	5	9,975	23,78

<b>Subtotal</b>	<b>2 609,00</b>
<b>Transport and other fees</b>	<b>0,00</b>
<b>GST</b>	<b>130,46</b>
<b>QST</b>	<b>260,24</b>
<b>TOTAL (CAD)</b>	<b>2 999,70</b>



## CAHIER DE CHARGE

### ÉQUIPEMENT ET LOCAUX CDL

	Francis Paquette	4926
	Gérald Delloye	4707
<b>Date requise</b>	<b>Besoins</b>	<b>Tâches</b>
Notes :		

### ÉLECTRICITÉ

	Réal Gaudet	4557
<b>Date requise</b>	<b>Besoins</b>	<b>Tâches</b>
Été 2017		
Notes :	Une génératrice a été louée pour tous les spectacles ayant lieu sur cette mini-scène.	

### MENUISERIE

	Vincent Labossière	4561
<b>Date requise</b>	<b>Besoins</b>	<b>Tâches</b>
28 juin à 10 h (suite 29 juin si requis)	Aide - installation structure	Aider à l'installation et stabilisation de la structure sur la Place publique. Il faudra probablement assembler les 2 morceaux de la structure. L'équipe d'étudiants sera aussi sur place. Le contact pour l'assemblage sera M. Richard Klopp (514-744-7500 poste 7239 ou 514-966-8496).
Lundi 2 octobre - 9 h	Aide - Démontage structure	Aider au démontage de la structure pour son transport vers Vanier.
Notes :		

### TRANSPORTS/MONTAGE/DÉMONTAGE

	Alexis Favron	4571
	Sylvain Arsenault	
<b>Date requise</b>	<b>Besoins</b>	<b>Tâches</b>
2017-06-28 à 9 h	Transport de la structure du Collège Vanier à la Place publique	Svp aller chercher la structure (mini-scène) au collège Vanier (Endroit: voir plan) et la porter sur la place publique. Nous serons sur place pour valider l'emplacement. Votre contact à Vanier est M. Richard Klopp (514-744-7500 poste 7239 ou 514-966-8496) ou Brendan Flynn (514 241-2599)
Lundi 2 octobre - 13 h	Démontage - Transport de la structure vers Vanier	Svp ramener la structure au Collège Vanier - mieux lieux que la collecte.
Notes :	<a href="https://www.google.ca/maps/dir/45.5134218,-73.6823666/45.5165082,-73.6714476/@45.5160276,-73.6789793,900m/data=!3m1!1e3!4m2!4m1!3e0">https://www.google.ca/maps/dir/45.5134218,-73.6823666/45.5165082,-73.6714476/@45.5160276,-73.6789793,900m/data=!3m1!1e3!4m2!4m1!3e0</a>	

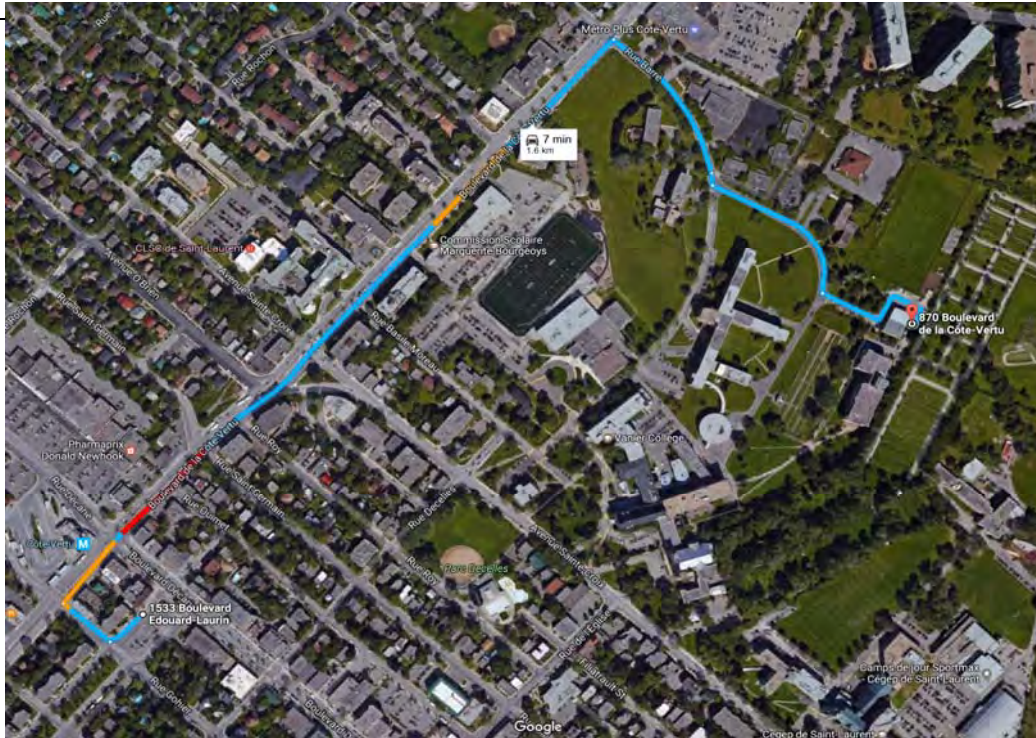





PLACE  
RODOLPHE-  
ROUSSEAU

LES VÉLOS MUSICAUX





ARTICLES  
POUR  
VAPOTEURS

ARTICLES  
POUR  
VAPOTEURS

EXCÉPTE  
MOTOCYCLES

7



